









{Floorplan}

With 23,000 sq ft of industrial style space in the heart of London, CodeNode hosts thousands of conferences, meetups, training courses and collaborative workshops each year. Our large exhibition and breakout area, com with an array of vintage sofa seating, ping pong tables and our fully-licensed {SpaceBar}, provides the ideal environment for learning and networking at your event.

Every booking is tailor- made to suit our clients' individual requirements, so you can relax knowing that your event will be in safe hands with an experienced event team and in-house AV services.

Please note the plans are not shown to scale.

LEGEND

-  Fire exit
-  Goods lift
-  Accessible lift
-  Cloakroom
-  Ladies' toilets
-  Gents' toilets
-  Accessible toilets
-  Folding wall

Ground floor

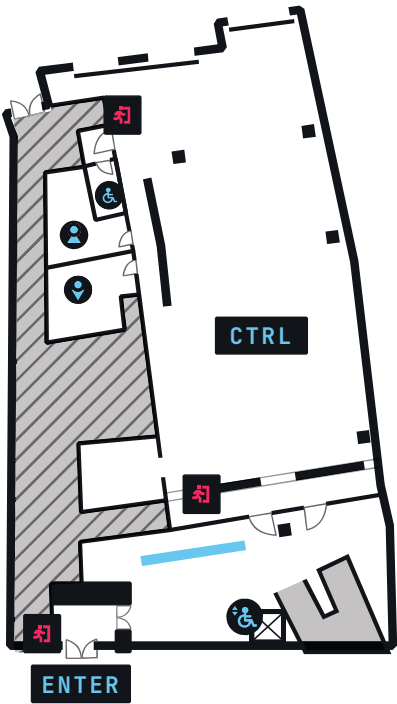

Lower ground floor

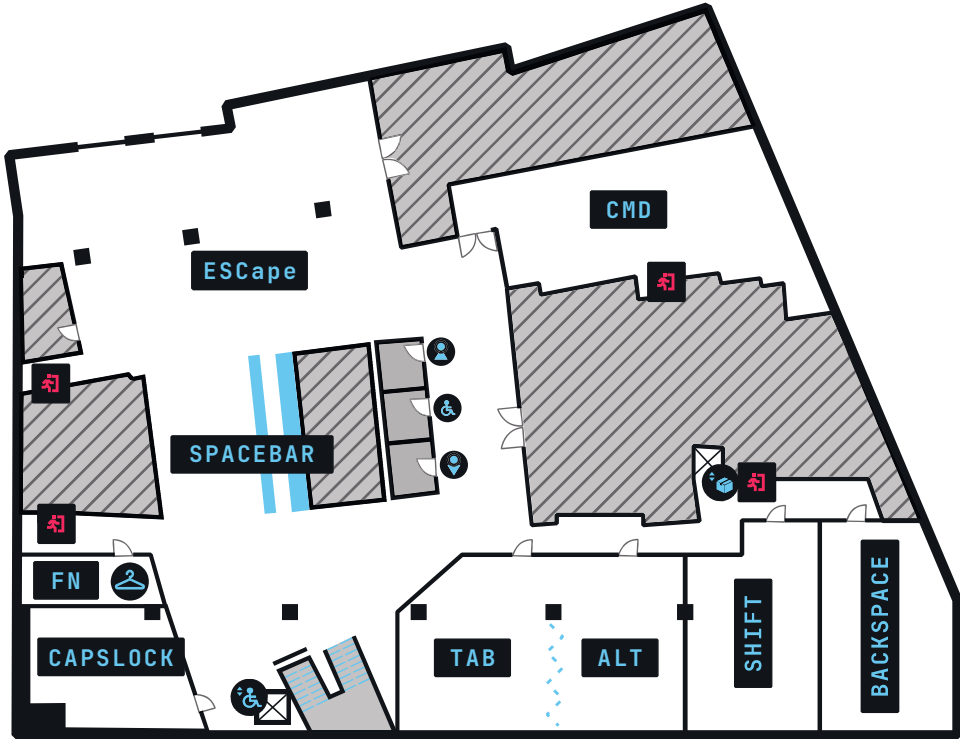

STYLE	CTRL ^{2.0}	CMD	TAB	ALT	SHIFT	BACKSPACE	ALT/TAB (opened up)
Theatre	330	120	80	80	80	80	150
Cabaret	150	80	48	48	48	48	96
Classroom	150	66	38	38	38	38	80
Boardroom	-	-	28	28	28	-	-
Total area	300 m2	125 m2	76 m2	78 m2	67 m2	77m2	147 m2